



SERIES 36 AND 46 FULL PORT - MULTIPORT - 3 & 4-WAY BALL VALVES

36 & 46 Series



**Full Port Design • Four Seats
Standard • All Valves Direct
Mount to Actuators**

- 100% air tested underwater at 80 psi
- Temperature range -20° to 450° F
- End cap type : Threaded, Socket weld, Butt weld. 150# And 300# flanged versions.
- Available in stainless steel or carbon steel
- Body & end are investment cast
- Self adjusting stem packing
- Available in 3 way & 4 way
- Available in T-port, L-port and X-port design
- Blow-out proof stem design
- Exclusive Pyramidal Stem Seal Design

MATERIALS LIST

NO.	PART NAME	MATERIAL	Q'TY
1	End Cap	A351 Gr. CF8M A216 Gr. WCB	3
2	Gasket	PTFE	4
3	Body	A351 Gr. CF8M A216 Gr. WCB	1
4	Ball	SS 316	1
5	Seat	PTFE/RPTFE	4
6	Stem	SS 316	1
7	Stem Seal	RPTFE	1
8	O-Ring	VITON	1
9	Stem Packing	GRAPHITE/PTFE	1
10	Gland	SS 304	1
11	Belleville Washer	SS 301	2
12	Stem Nut	SS 304	1
13	Nut Stop	SS 304	1
14	Space Washer	SS 304	1
15	Lock Saddle	SS 304	1
16	Handle Nut	SS 304	1
17	Handle	SS 304	1
18	Handle Sleeve	Vinyl	1
19	Stop Pin	SS 304	1
20	INSERT PIN	SS 316	1

Compliance Standards Flanged (Class 150/300)

Threaded / SW & BW Ends Valve Design: ASME B16.34
 ASME/ANSI B16.34 Pressure Test: API598
 API598 Steel Casting: MSS SP-55
 ASTM A351
 ISO5211
 MSS-SP-55

DIMENSIONS (in)

SIZE	ØA	B	ØC	ØD	ØD1	E	H	H1	H2	H3	ØI	ØF	L	*L	♦L	M	Port	M1	M2	W	ISO5211	Weight Tbd/Flg.
¼"	.25	.35	.49	.67	.55	5.12	2.44	1.51	.39	.38	1.41	1.65	3.46			.43	.43	.23	.23	1.73	F03/F04	1.5/NA
⅜"	.37	.35	.57	.74	.68	5.12	2.44	1.51	.39	.38	1.41	1.65	3.46			.43	.43	.23	.23	1.73	F03/F04	1.5/NA
½"	.50	.35	.68	.84	.85	5.12	2.44	1.61	.39	.39	1.41	1.65	4.12	5.98	6.30	.50	.50	.23	.23	2.06	F03/F04	1.8/3.2
¾"	.75	.43	.88	1.08	1.06	6.5	3.23	1.93	.51	.51	1.65	1.97	4.41	6.57	6.97	.56	.75	.23	.28	2.20	F04/F05	2.5/6.1
1"	1.0	.43	1.10	1.35	1.33	6.5	3.50	2.17	.51	.61	1.65	1.97	5.04	7.50	7.88	.62	1.00	.23	.28	2.52	F04/F05	5.8/7.9
1¼"	1.25	.55	1.37	1.68	1.67	8.07	3.86	2.48	.66	.65	1.97	2.76	5.51	8.19	8.58	.68	1.25	.28	.36	2.75	F05/F07	7.9/NA
1½"	1.50	.55	1.61	1.93	1.91	8.07	4.25	2.91	.66	.68	1.97	2.76	6.30	8.68	9.21	.75	1.50	.28	.36	3.15	F05/F07	12/39
2"	2.00	.67	2.12	2.40	2.40	12.8	5.50	3.66	.86	1.02	2.76	4.02	7.56	9.96	10.75	.87	2.00	.36	.44	3.78	F07/F10	21/50

End Cap Type L: threaded, socket weld, butt weld *L: 150# L: 300#

**Series 36 3-Way
L or T Port**

**Series 46 4-Way
L, T or X Port**

1/4" to 2"
 1/4" to 1" 1000 psi
 1-1/4" to 2" 800 psi
 Flanged to 150# and 300#

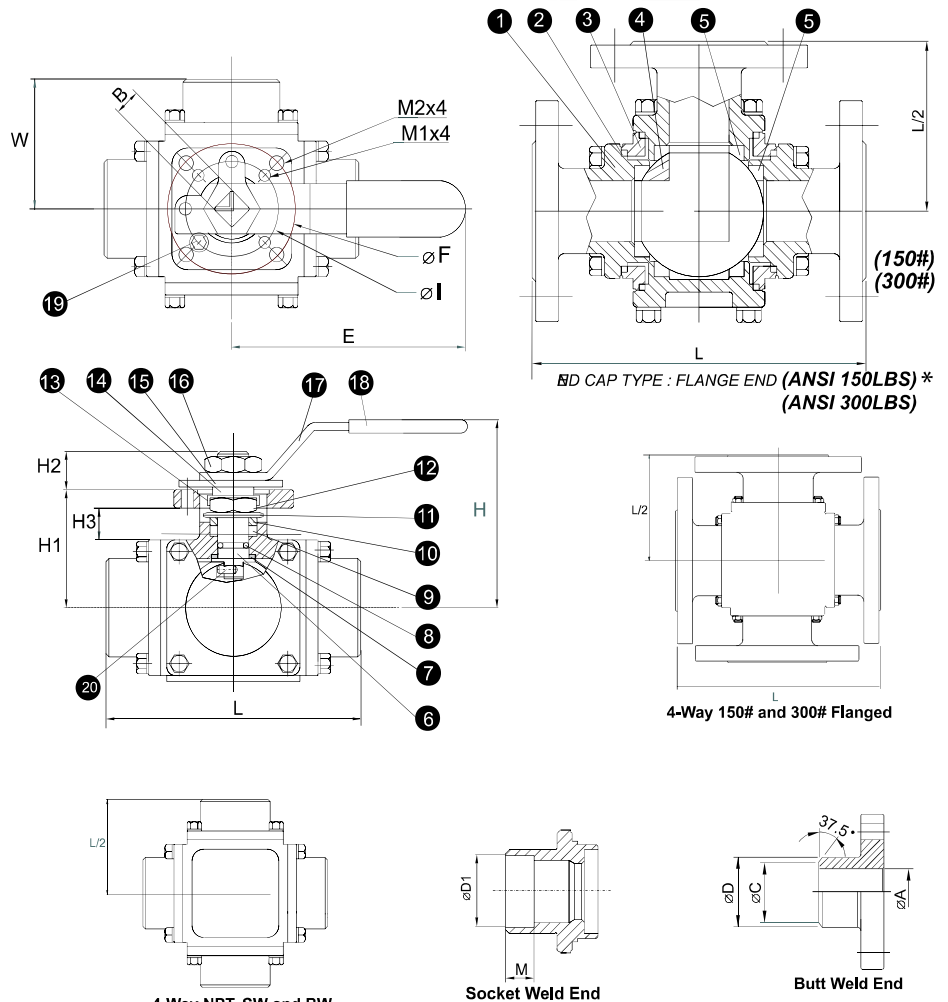

4-Way NPT, SW and BW

Socket Weld End

Butt Weld End

Series 36 & 46 Multiport 3 and 4-way valves

Full Port, L, T or X option

2-1/2" to 4"

Flanged End ANSI Class

MATERIALS LIST

NO.	PART NAME	MATERIAL	Q'TY
1	Flange End Cap	A351 Gr. CF8M A216 Gr. WCB	3
2	Body	A351 Gr. CF8M A216 Gr. WCB	1
3	Ball & Stem	SS 316	1
4	Housing	RPTFE+STAINLESS	1
5	Seats	RPTFE	4
6	Gasket	PTFE	4
7	O-Ring	VITON	1
8	Stem Packing	GRAPHITE/PTFE	1
9	Gland Washer	SS 304	1
10	Belleville Washer	SS 301	2
11	Gland	SS 304	1
12	Handle Head	A351 Gr. CF8	1
13	Stop Pin	SS 304	1
14	Bolt	SS 304	1
15	Lever	CARBON STEEL	1
16	Blank End	A351 Gr. CF8M	1
17	Connection Bolts	SS 304	8
18	Bolt Nuts	SS 304	16

2-1/2" to 4"

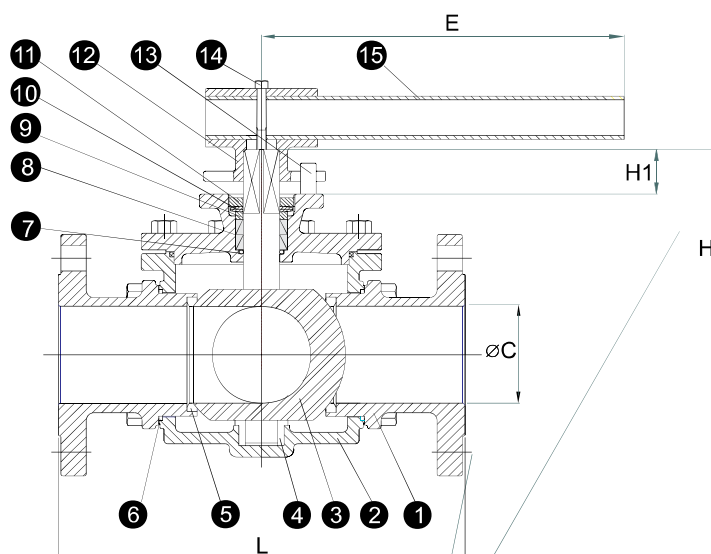
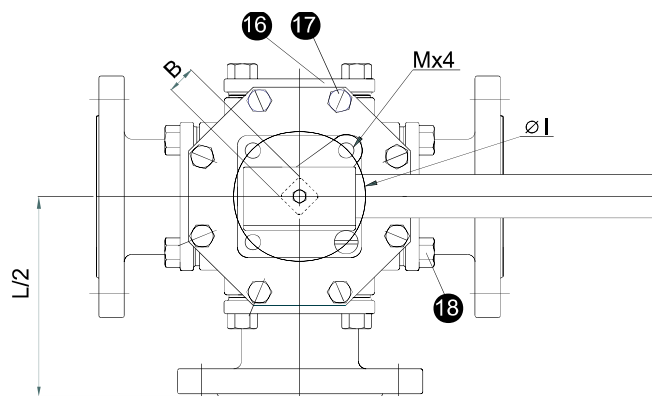

Dimensions

SIZE	B	C	E	H	H1	I	L		M	ISO5211	Weight 3W/4W
							150#	300#			
2 1/2"	.86"	2.44	15.76	5.67	.98	4.00	11.82	11.82	.43	F10	80/95
3"	.86"	3.00	19.1	6.38	.98	4.00	12.01	12.75	.43	F10	105/135
4"	.86"	3.78	25.61	7.17	.98	4.00	14.51	15.01	.43	F10	220/290

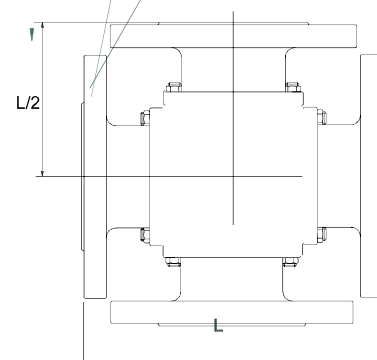

4-Way 150# and 300# Flanged

I. PYRAMIDAL MACHINED STEM WITH STEM SEAL

All valves come standard with direct mount actuator capabilities and our patented live loaded high cycle pyramidal stem seal design. The wedging action of the stem is far superior to flat stem design when it comes to effective wear compensation. For more information on this design please request Triad's Pyramidal Stem Design data sheet.

Standard Design

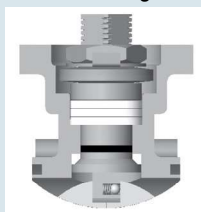

High Temp Design

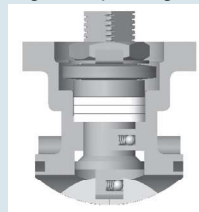

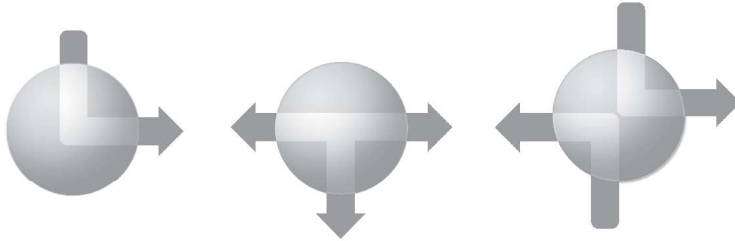

Flow Patterns

Cv values Size	Straight Through	L Port	One Side of Cross Port
1/4 and 3/8"	5.2	3.5	2.8
1/2"	15	11	9
3/4"	16	12	10
1"	45	25	20
1-1/4"	46	26	21
1-1/2"	101	57	47
2"	180	100	79
2-1/2"	200	117	83
3"	229	128	90
4"	405	226	180

Three Way T Port 36T

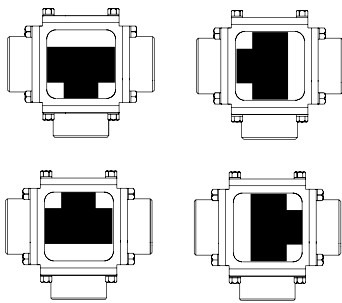

Four Way T Port 46T

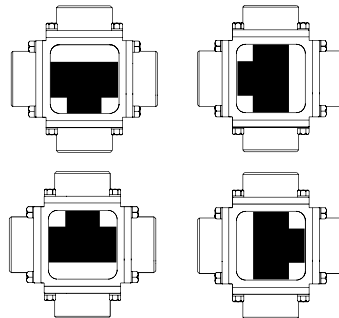

Three Way L Port 36L

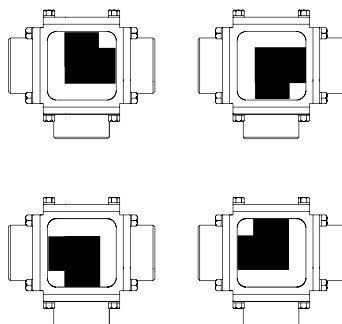

Four Way L Port 46L

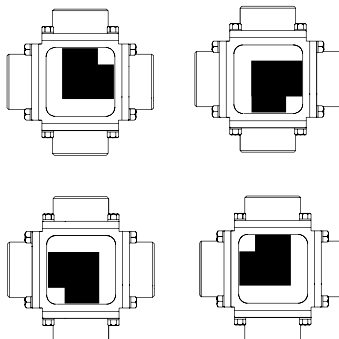

Four Way Cross Port 46X

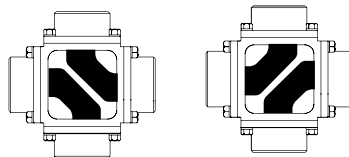

Ordering Information

Prefix:

36T 3 Way T Port

36L 3 Way L Port

46T 3 Way T Port

46L 4 Way L Port

46X 4 Way Cross Port

Suffix

62011 NPT

72011 Socket Weld

82011 Butt Weld

9150-22R 150# Flanged

9300-22R 300# Flanged

All valve stocked 316SS body,
stem and ball

RPTFE seats and seals

**Various optional seats avail-
able**



Triad also offers clamp
end 3 ways. See bulletin 30-92061